

RF1 TYPE 01

BNC Right Angle Female PCB Mount

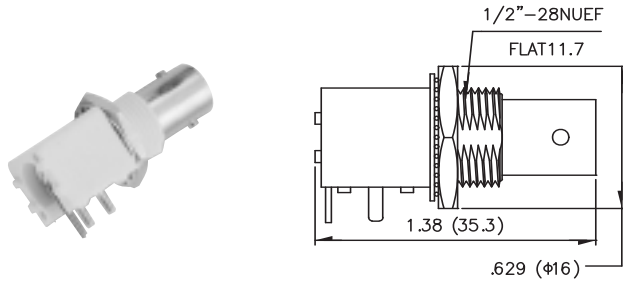

RF1 TYPE 01V

BNC Straight Female PCB Mount

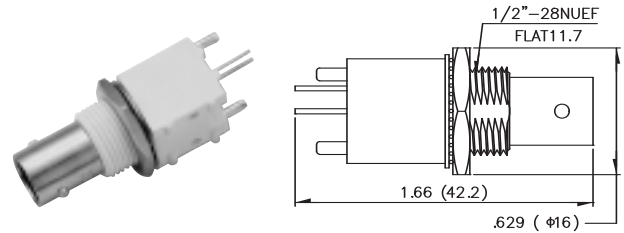

RF1 TYPE 01A

BNC High Profile Right Angle Female PCB Mount

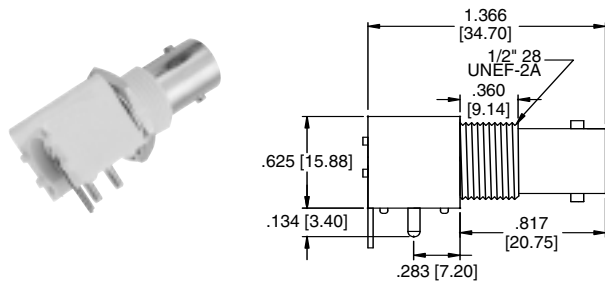

RF1 TYPE 03

BNC Male Crimp

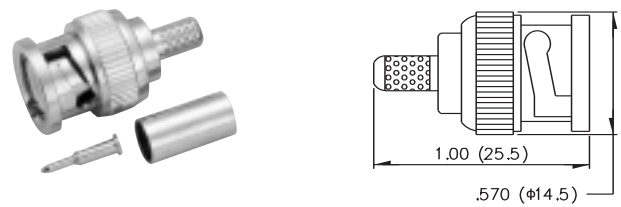

RF1 TYPE 04

BNC Female Bulkhead Crimp

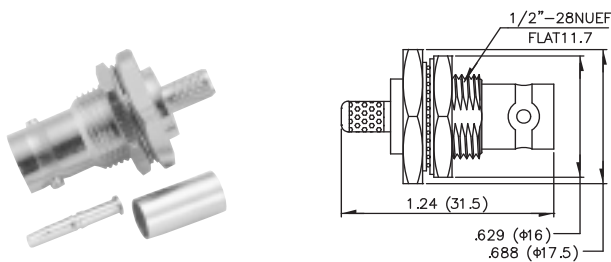

RF1 TYPE 05

BNC Male to BNC Double Female

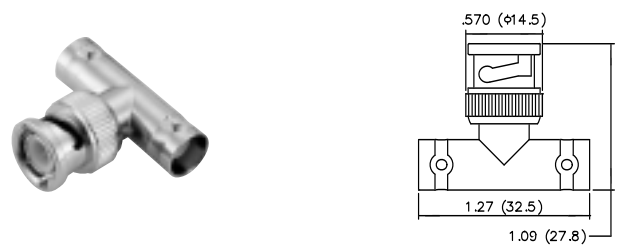

RF1 TYPE 06

BNC Male "Y" Adapter

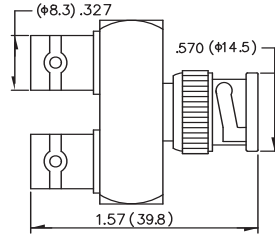

RF1 TYPE 07

BNC Female PC Board Mount

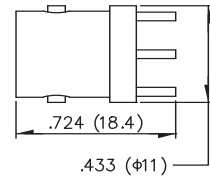

RF2 TYPE 01

SMA Right Angle Male Crimp Type

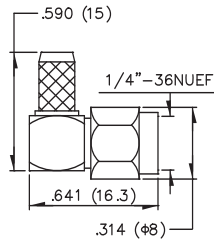

RF2 TYPE 02

SMA Male Crimp Type

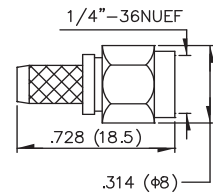

RF2 TYPE 03

SMA Right Angle Female PC Board Mount

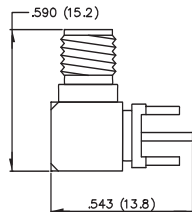

RF2 TYPE 04

SMA Female PC Board Mount

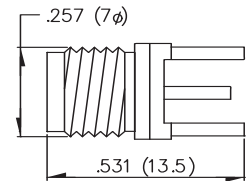

RF2 TYPE 05

SMA Female Chassis Crimp

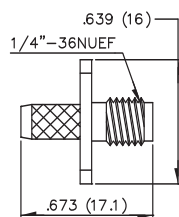
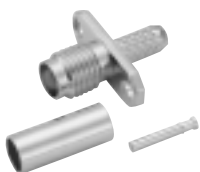

RF2 TYPE 06

SMA Female Bulkhead Crimp

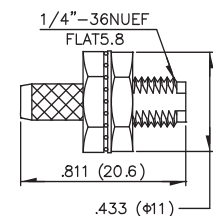

RF2 TYPE 07

SMA Female Bulkhead Crimp

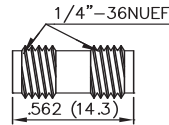

RF3 TYPE 01

SMB Male Crimp

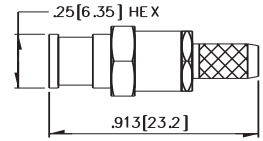

RF3 TYPE 02

SMB Female Crimp

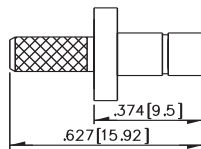
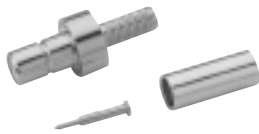

RF3 TYPE 03

SMB Male Right Angle Crimp

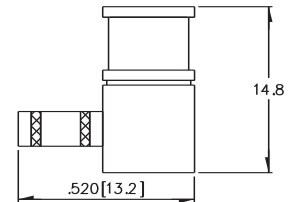
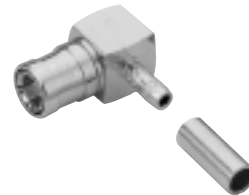

RF3 TYPE 04

SMB Right Angle Male PCB Mount

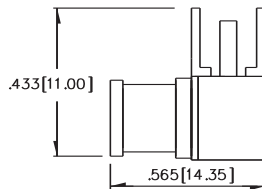

RF3 TYPE 05

SMB Female PCB Mount

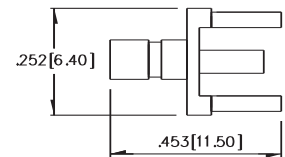

RF3 TYPE 06

SMB Right Angle Female PCB Mount

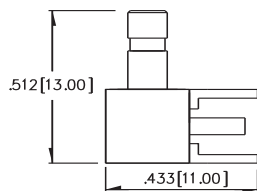

RF4 TYPE 01

F Female Right Angle PCB mount

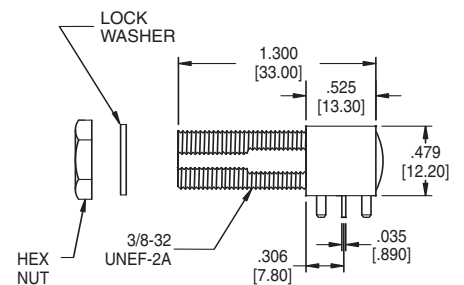

RF4 TYPE 02
F Male To Male

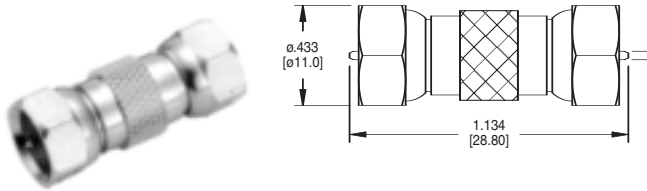

RF5 TYPE 01
N Male Crimp Type

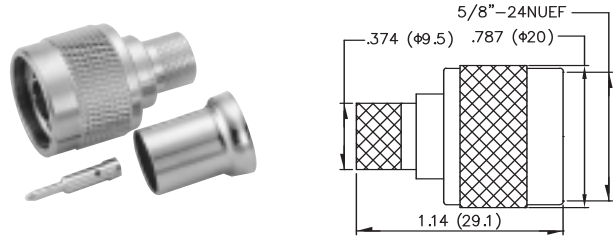

RF5 TYPE 02
N Female Panel Receptacle



RF8 TYPE 01
FME Male Crimp

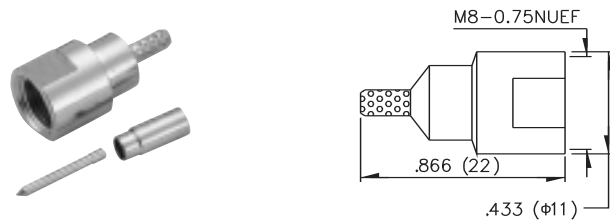

RF8 TYPE 02
FME Male To BNC Male

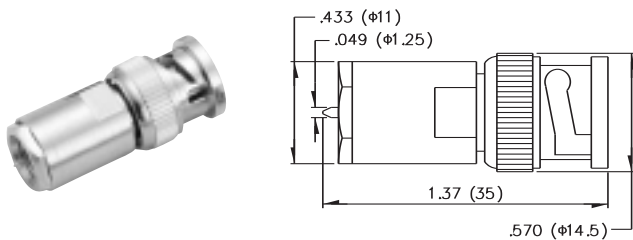

RF7 TYPE 01
TNC Male Crimp

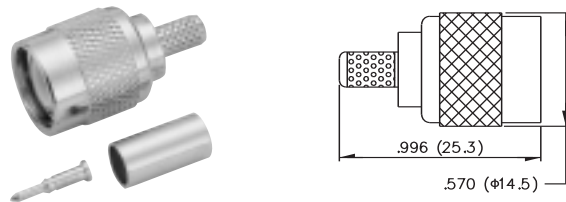

RF9 TYPE 01
MINI UHF Male Crimp Type

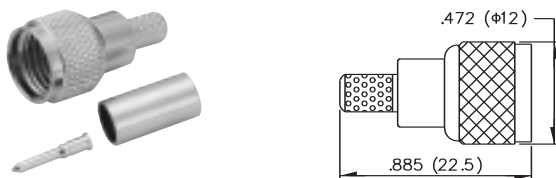

RF6 TYPE 01
UHF Double Female

