

IEC-A

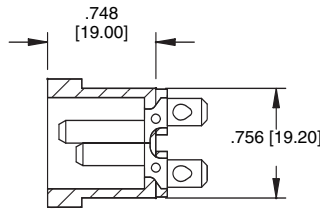

IEC-A-1

1.075 [27.30] Front Mounting
1.212 [30.80] Rear Mounting

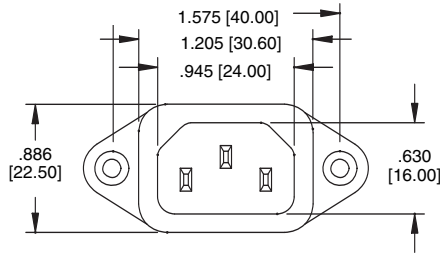
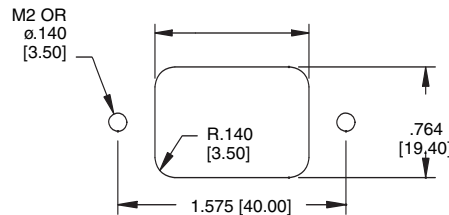
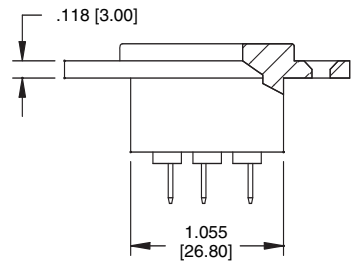

| TERMINAL OPTIONS | | | |
|------------------|-----------|-------------|-------------|
| 1 | 2 | 3 | 5 |
| .187 Q.C. | .250 Q.C. | .157 Solder | .098 Solder |
| | | | |

IEC-A RIGHT ANGLE PCB

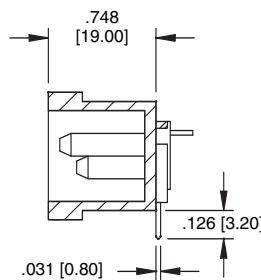
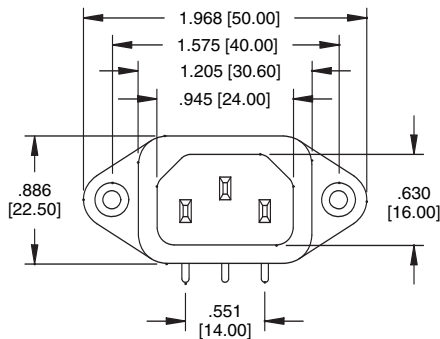

IEC-A-4

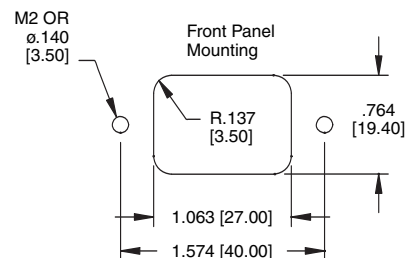
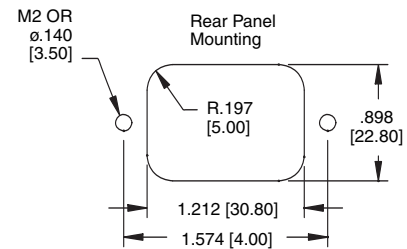

IEC-C UNIVERSAL PANEL SNAP

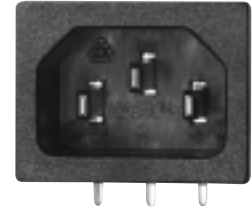
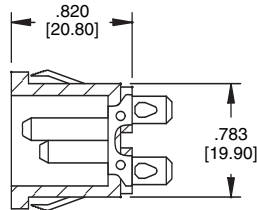
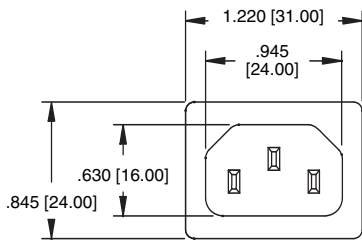

IEC-C-4

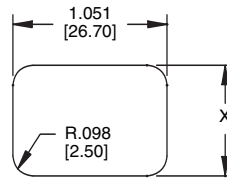
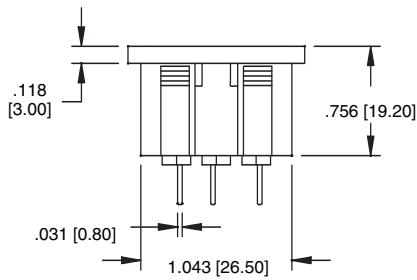

Recommended Panel
Thickness: 0.80mm - 3.0mm

| PANEL THICKNESS | DIM X |
|---------------------|-------------|
| .031-.039 [0.8-1.0] | .780 [19.8] |
| .039-.059 [1.0-1.5] | .784 [19.9] |
| .079-.119 [2.0-3.0] | .788 [20.0] |

| TERMINAL OPTIONS | | | |
|------------------|-----------|-------------|-------------|
| 1 | 2 | 3 | 5 |
| .187 Q.C. | .250 Q.C. | .157 Solder | .098 Solder |
| | | | |

IEC-C DEDICATED PANEL SNAP

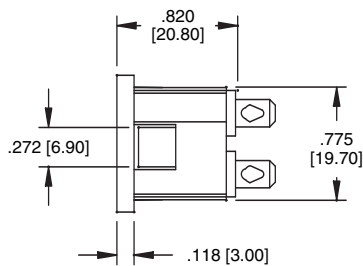
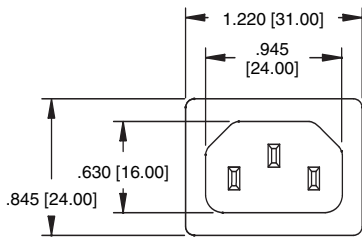

IEC-C-1-150

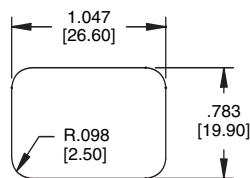
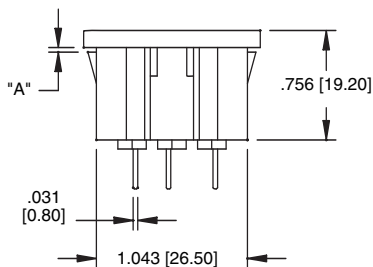

Recommended
Panel Cut-Out

| PART NUMBER | DIM "A" |
|-------------|-------------|
| IEC-C-X-080 | .031 [0.80] |
| IEC-C-X-150 | .059 [1.50] |
| IEC-C-X-300 | .118 [3.00] |

| TERMINAL OPTIONS | | | |
|------------------|-----------|-------------|-------------|
| 1 | 2 | 3 | 5 |
| .187 Q.C. | .250 Q.C. | .157 Solder | .098 Solder |
| | | | |

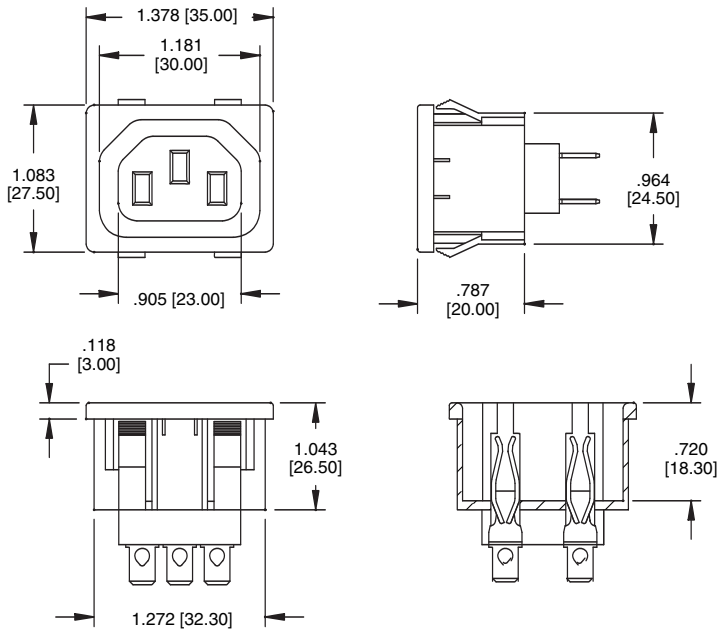

| PANEL THICKNESS | DIM X |
|---------------------|-------------|
| .031-.039 [0.8-1.0] | .780 [19.8] |
| .039-.059 [1.0-1.5] | .784 [19.9] |
| .079-.119 [2.0-3.0] | .788 [20.0] |

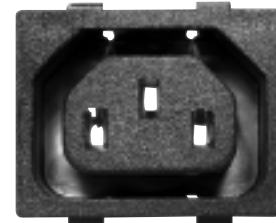

**IEC-D
UNIVERSAL
PANEL
SNAP**

IEC-D-1

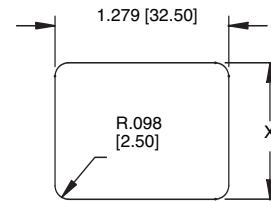

**Recommended Panel Thickness:
0.8mm - 3.0mm**

| TERMINAL OPTIONS | | |
|------------------|-----------|-------------|
| 1 | 2 | 3 |
| .187 Q.C. | .250 Q.C. | .157 Solder |
| | | |

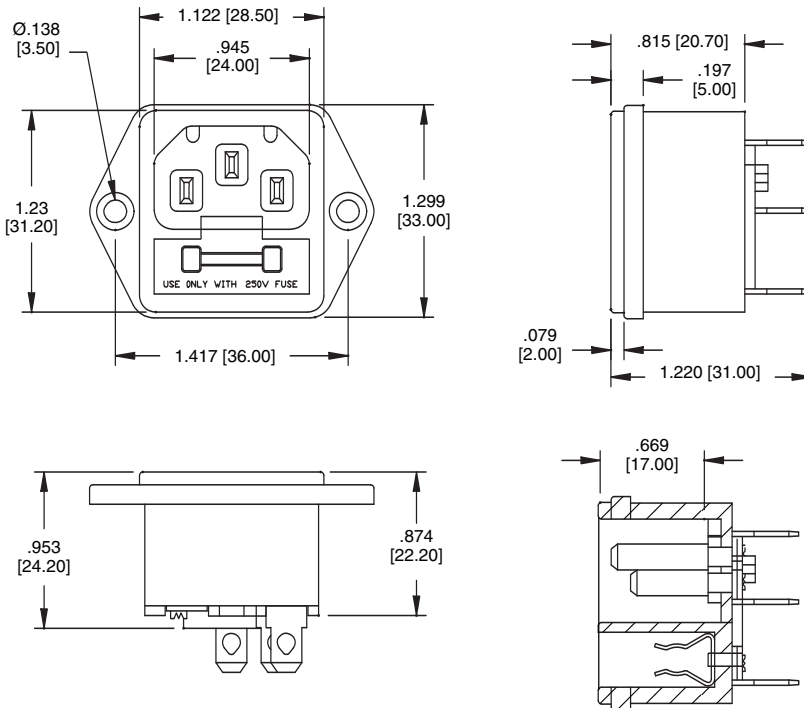

IEC-F

IEC-F-1

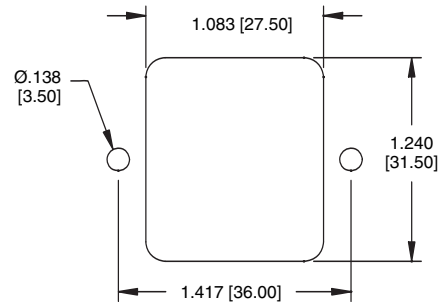

Recommended Panel Cut-Out

Recommended PCB Layout

IEC-E

IEC-EW-4

Recommended Panel Cut-Out

| DIMENSIONAL | | |
|-------------|-------------|-------------|
| | F | W |
| IEC-EW | .287 [7.30] | .276 [7.00] |
| IEC-EX | .287 [7.30] | .358 [9.10] |
| IEC-EY | .382 [9.70] | .276 [7.00] |
| IEC-EZ | .382 [9.70] | .358 [9.10] |

Recommended PCB Layout

IEC-B

IEC-B-1

Recommended Panel Cut-Out

| TERMINAL OPTIONS | | |
|------------------|-----------|-------------|
| 1 | 2 | 3 |
| .187 Q.C. | .250 Q.C. | .157 Solder |

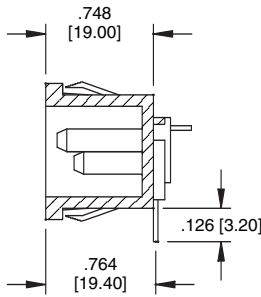
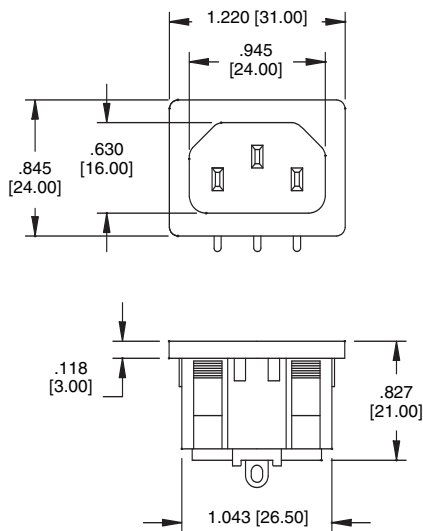

**IEC-J
UNIVERSAL PANEL SNAP
RIGHT ANGLE PCB**



IEC-J-4

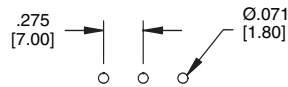

**Recommended Panel
Cut-Out**

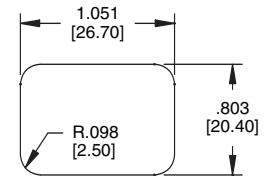

**Recommended Panel
Thickness: 0.80mm - 3.0mm**

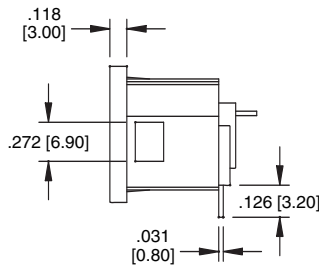
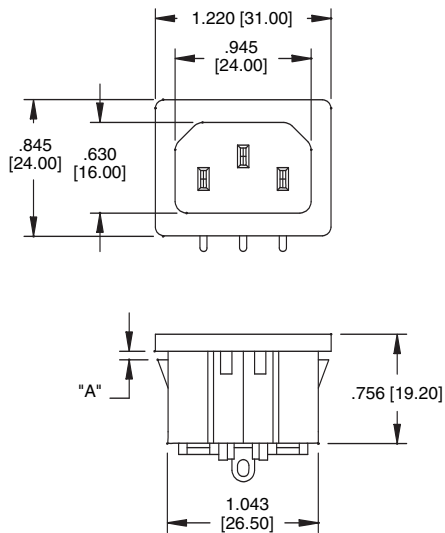

**IEC-J
DEDICATED PANEL SNAP
RIGHT ANGLE PCB**



IEC-J-4-150

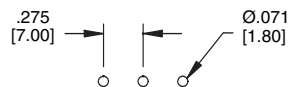

**Recommended PCB
Layout**

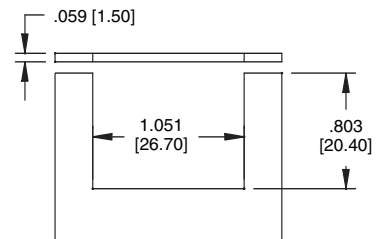

Recommended Panel Cut-Out

| PART NUMBER | DIM "A" |
|-------------|-------------|
| IEC-J-4-120 | .047 [1.20] |
| IEC-J-4-150 | .059 [1.50] |
| IEC-J-4-200 | .079 [2.00] |
| IEC-J-4-300 | .118 [3.00] |

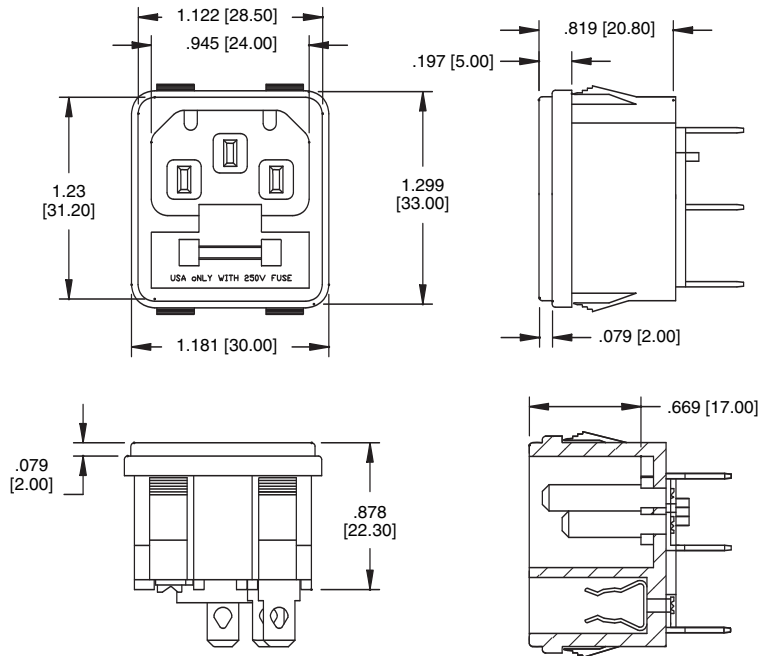

**IEC-G
UNIVERSAL
PANEL
SNAP**

IEC-G-1

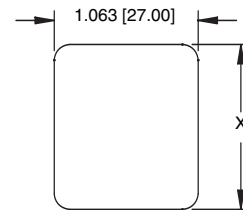

Panel cut-out thickness:
0.80mm - 3.2mm

| PANEL THICKNESS | DIM X |
|---------------------|---------------|
| .031-.071 [0.8-1.8] | 1.240 [31.50] |
| .075-.126 [1.9-3.2] | 1.248 [31.70] |

| TERMINAL OPTIONS | | |
|------------------|-----------|-------------|
| 1 | 2 | 3 |
| .187 Q.C. | .250 Q.C. | .157 Solder |
| | | |

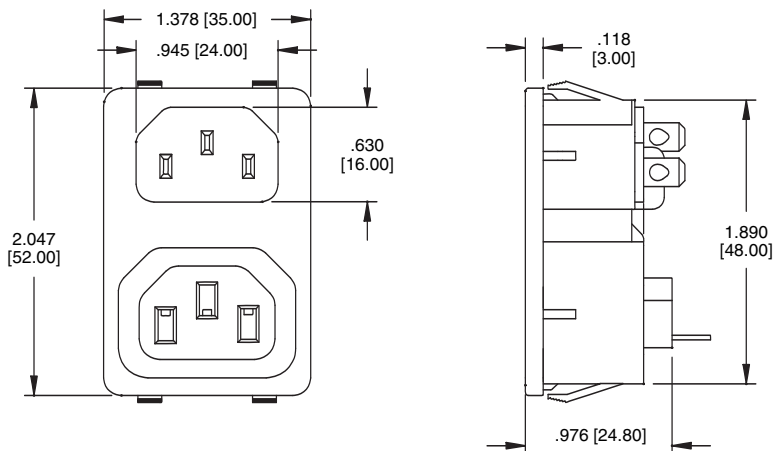

**IEC-HS
UNIVERSAL PANEL SNAP**

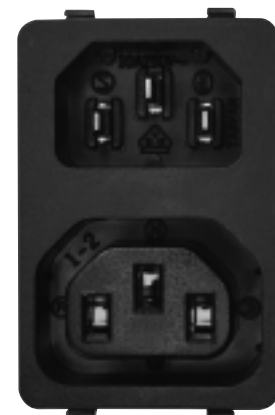

IEC-HS-1

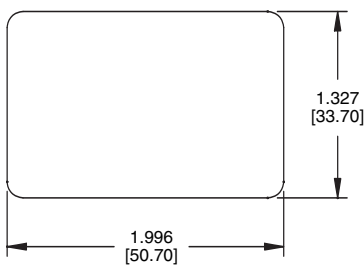

**Recommended
Panel Cut-Out**